



**WASI**<sup>®</sup>



NORM

**ANKERI**

**50 YEARS**

**EXCELLENCE IN STAINLESS STEEL**  
**EXCELLENCE IN STAINLESS STEEL**

# WS 9350

## Anchor studs VA-A



d	length	clamping range
M8	110	20
M10	130	30
M12	160	35
M14	170	35
M16	165	45
M16	190	45
M20	260	60
M24	260	15

Grade	SU
●	10
●	10
●	10
●	10
●	10
●	10
●	10
●	5

■ A1 / ▲ A2 / ● A4 | SU: Sales unit | All measurements in mm | Other dimensions on request.

Example item no. 9350-4-8X110 WS 9350 - A4 - Ø 8mm - l = 110mm

# WS 9360

## Anchor capsules VA-P



d	boreholeØ x deepness mm
8	10X80
10	12X90
12	14X110
14	16X120
16	18X125
20	25X170
24	28X210
30	35X280

Grade	SU
-	10
-	10
-	10
-	10
-	10
-	10
-	5
-	5

■ A1 / ▲ A2 / ● A4 | SU: Sales unit | All measurements in mm | Other dimensions on request.

Example item no. 9360 8 WS 9360 - content = 8ml

# WS 9370

## Wedge anchor

type B



d	deepness mm	anchor length mm	clamping range da mm
6	60	67	10
8	65	75	10
8	65	80	15
8	65	95	30
10	70	85	10
10	70	90	15
10	70	120	45
12	90	110	15
16	110	150	30
16	110	180	60
20	130	150	5

Grade	SU
●	100
●	100
●	100
●	100
●	50
●	50
●	50
●	25
●	20
●	10
●	10

■ A1 / ▲ A2 / ● A4 | SU: Sales unit | All measurements in mm | Other dimensions on request.

Example item no. 9370-4-8X30 WS 9370 - A4 - Ø 8mm - l = 30mm

# WS 9372

## Wedge anchor

type Z



d	deepness mm	anchor length mm	clamping range da mm
8	75	75	15
10	75	95	10
10	75	95	15
10	75	95	30
10	75	95	50
12	90	110	15
12	90	110	30
12	90	110	50
16	105	140	25
20	115	160	60

Grade	SU
●	100
●	50
●	50
●	50
●	50
●	25
●	25
●	25
●	20
●	20

■ A1 / ▲ A2 / ● A4 | SU: Sales unit | All measurements in mm | Other dimensions on request.  
 Example item no. 9372-4-8-15 WS 9372 - A4 - Ø 8mm - clamping width = 15mm

# WS 9375

## Heavy duty anchor

type SL



d	deepness	anchor length mm	clamping range mm
14	73	100	10
14	73	115	25
14	73	140	50
14	73	165	75
14	73	185	100
14	73	210	125
14	73	245	160

Grade	SU
●	25
●	25
●	25
●	25
●	25
●	25
●	25

■ A1 / ▲ A2 / ● A4 | SU: Sales unit | All measurements in mm | Other dimensions on request.

Example item no. 9375-4-14-25 WS 9375 - A4 - M10 - 14-25 SL

# WS 9380

## Drop in anchor

type E

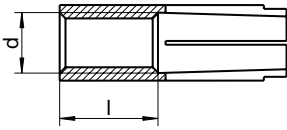

nominal size	thread	thread length	borehole Ø X deepn. mm
E5	M 5	10	8 X 28
E6	M 6	13	8 X 33
E8	M 8	13	10 X 33
E10	M 10	15	12 X 44
E12	M 12	18	15 X 54
E16	M 16	23	20 X 71
E20	M 20	34	25 X 86

Grade	SU
●	100
●	100
●	100
●	50
●	50
●	25
●	25

■ A1 / ▲ A2 / ● A4 | SU: Sales unit | All measurements in mm | Other dimensions on request.  
 Example item no. 9380-4-8 WS 9380 - A4 - Ø 8mm