

Vidna stakla - laterne

laterna DIN-zavarivanje
sight glass DIN-weld. ends

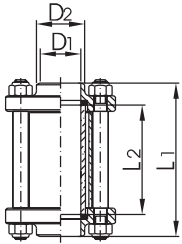

| DN | D1 | D2 | L1 | L2 | Tež.[kg] |
|-----|-----|-----|-----|-----|----------|
| 10 | 10 | 15 | 88 | 60 | 0,25 |
| 15 | 16 | 21 | 88 | 60 | 0,30 |
| 20 | 20 | 25 | 88 | 60 | 0,73 |
| 25 | 26 | 31 | 98 | 70 | 0,75 |
| 32 | 32 | 37 | 104 | 70 | 0,76 |
| 40 | 38 | 43 | 112 | 70 | 1,08 |
| 50 | 50 | 55 | 112 | 70 | 1,34 |
| 65 | 66 | 72 | 127 | 85 | 1,90 |
| 80 | 81 | 87 | 135 | 85 | 2,35 |
| 100 | 100 | 106 | 169 | 115 | 2,80 |
| 125 | 125 | 132 | 202 | 160 | 6,35 |
| 150 | 150 | 157 | 216 | 170 | 7,11 |

laterne DIN-navoj
sight glass DIN male/male

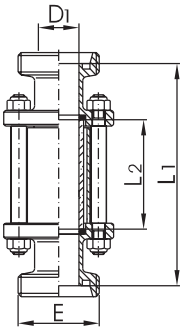

| DN | D1 | L1 | L2 | E | Tež.[kg] |
|-----|-----|-----|-----|---------------|----------|
| 10 | 10 | 122 | 60 | Rd 28 x 1/8" | 0,32 |
| 15 | 16 | 122 | 60 | Rd 34 x 1/8" | 0,39 |
| 20 | 20 | 124 | 60 | Rd 44 x 1/6" | 0,90 |
| 25 | 26 | 142 | 70 | Rd 52 x 1/6" | 1,00 |
| 32 | 32 | 154 | 70 | Rd 58 x 1/6" | 1,08 |
| 40 | 38 | 164 | 70 | Rd 65 x 1/6" | 1,50 |
| 50 | 50 | 168 | 70 | Rd 78 x 1/6" | 1,94 |
| 65 | 66 | 191 | 85 | Rd 95 x 1/6" | 2,80 |
| 80 | 81 | 209 | 85 | Rd 110 x 1/4" | 3,10 |
| 100 | 100 | 257 | 115 | Rd 130 x 1/4" | 4,36 |
| 125 | 125 | 270 | 160 | Rd 160 x 1/4" | 8,80 |
| 150 | 150 | 290 | 170 | Rd 190 x 1/4" | 10,50 |

laterna DIN-navoj/linar
sight glass DIN-male/linar

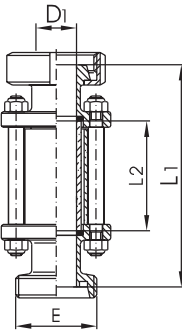

| DN | D1 | L1 | L2 | E | Tež.[kg] |
|-----|-----|-----|-----|---------------|----------|
| 10 | 10 | 122 | 60 | Rd 28 x 1/8" | 0,38 |
| 15 | 16 | 122 | 60 | Rd 34 x 1/8" | 0,45 |
| 20 | 20 | 124 | 60 | Rd 44 x 1/6" | 0,69 |
| 25 | 26 | 142 | 70 | Rd 52 x 1/6" | 1,02 |
| 32 | 32 | 154 | 70 | Rd 58 x 1/6" | 1,25 |
| 40 | 38 | 164 | 70 | Rd 65 x 1/6" | 1,67 |
| 50 | 50 | 168 | 70 | Rd 78 x 1/6" | 2,17 |
| 65 | 66 | 191 | 85 | Rd 95 x 1/6" | 3,26 |
| 80 | 81 | 209 | 85 | Rd 110 x 1/4" | 3,71 |
| 100 | 100 | 257 | 115 | Rd 130 x 1/4" | 5,10 |
| 125 | 125 | 270 | 160 | Rd 160 x 1/4" | 9,50 |
| 150 | 150 | 290 | 170 | Rd 190 x 1/4" | 11,30 |

laterna DIN-linar/linar
sight glass DIN-linar/linar

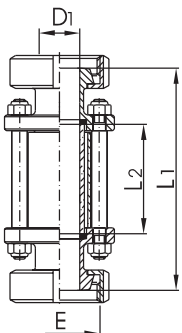

| DN | D1 | L1 | L2 | E | Tež.[kg] |
|-----|-----|-----|-----|---------------|----------|
| 10 | 10 | 122 | 60 | Rd 28 x 1/8" | 0,44 |
| 15 | 16 | 122 | 60 | Rd 34 x 1/8" | 0,52 |
| 20 | 20 | 124 | 60 | Rd 44 x 1/6" | 1,08 |
| 25 | 26 | 142 | 70 | Rd 52 x 1/6" | 1,20 |
| 32 | 32 | 154 | 70 | Rd 58 x 1/6" | 1,41 |
| 40 | 38 | 165 | 70 | Rd 65 x 1/6" | 1,89 |
| 50 | 50 | 168 | 70 | Rd 78 x 1/6" | 2,50 |
| 65 | 66 | 191 | 85 | Rd 95 x 1/6" | 3,64 |
| 80 | 81 | 209 | 85 | Rd 110 x 1/4" | 4,27 |
| 100 | 100 | 257 | 115 | Rd 130 x 1/4" | 6,13 |
| 125 | 125 | 270 | 160 | Rd 160 x 1/4" | 10,20 |
| 150 | 150 | 290 | 170 | Rd 190 x 1/4" | 11,79 |

Vidna stakla - laterne i delovi

Laterna, col-za zavarivanje
sight glass inch-weld. ends

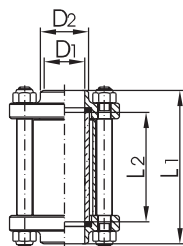

| DN | D1 | D2 | L1 | L2 | Tež.[kg] |
|--------|------|-----|-----|-----|----------|
| 1" | 22,9 | 28 | 96 | 70 | 0,72 |
| 1 1/4" | 29,3 | 35 | 102 | 70 | 0,78 |
| 1 1/2" | 35,1 | 41 | 110 | 70 | 1,12 |
| 2" | 47,8 | 54 | 110 | 70 | 1,38 |
| 2 1/2" | 60,5 | 68 | 124 | 85 | 1,90 |
| 3" | 72,1 | 78 | 132 | 85 | 2,35 |
| 4" | 97,6 | 104 | 167 | 115 | 2,80 |

Stakleni cilindar za laterne
cylinder for sight glass

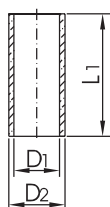

| DN | D1 | D2 | L1 | Tež.[kg] |
|-------------|-----|-----|-----|----------|
| 10 | 10 | 15 | 60 | 0,02 |
| 15 | 17 | 22 | 60 | 0,02 |
| 20 | 20 | 26 | 60 | 0,03 |
| 25 + 1" | 26 | 32 | 70 | 0,04 |
| 32 + 1 1/4" | 34 | 40 | 70 | 0,06 |
| 40 + 1 1/2" | 40 | 50 | 70 | 0,11 |
| 50 + 2" | 50 | 60 | 70 | 0,14 |
| 2 1/2" | 60 | 70 | 85 | 0,18 |
| 65 | 65 | 75 | 85 | 0,21 |
| 3" | 75 | 85 | 90 | 0,27 |
| 80 | 80 | 90 | 85 | 0,30 |
| 100 + 4" | 100 | 110 | 115 | 0,43 |
| 125 | 126 | 140 | 160 | 1,12 |
| 150 | 152 | 170 | 170 | 1,80 |

Dichtung za vidno staklo-laternu
sealing for sight glass

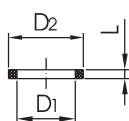

| DN | D1 | D2 | L1 | Tež.[kg] |
|-------------|-----|-----|----|----------|
| 10 | 10 | 16 | 3 | |
| 15 | 16 | 23 | 3 | |
| 20 | 20 | 27 | 3 | |
| 25 + 1" | 26 | 33 | 3 | |
| 32 + 1 1/4" | 32 | 39 | 3 | |
| 40 + 1 1/2" | 38 | 51 | 3 | |
| 50 + 2" | 50 | 61 | 3 | |
| 2 1/2" | 61 | 72 | 3 | |
| 65 | 66 | 76 | 3 | |
| 3" | 76 | 87 | 4 | |
| 80 | 81 | 91 | 4 | |
| 100 + 4" | 100 | 111 | 4 | |
| 125 | 125 | 141 | 4 | |
| 150 | 150 | 171 | 4 | |

Vidna stakla prema DIN 11850, delovi i oprema

Zaštitni cilindar od polikarbonata safety screen of polycarbonat

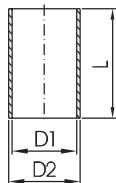

| DN | D1 | D2 | L | Tež.[kg] |
|-------------|-----|-----|-----|----------|
| 10 | 20 | 24 | 50 | 0,01 |
| 15 | 27 | 30 | 50 | 0,01 |
| 20 | 35 | 38 | 50 | 0,01 |
| 25 + 1" | 36 | 40 | 61 | 0,01 |
| 32 + 1 1/4" | 42 | 45 | 61 | 0,02 |
| 40 + 1 1/2" | 54 | 60 | 61 | 0,02 |
| 50 + 2" | 66 | 70 | 61 | 0,03 |
| 65 + 2 1/2" | 80 | 88 | 75 | 0,04 |
| 80 + 3" | 95 | 100 | 77 | 0,04 |
| 100 + 4" | 128 | 133 | 103 | 0,07 |
| 125 | 164 | 170 | 144 | 0,12 |
| 150 | 194 | 200 | 158 | 0,17 |

Zaštitni cilindar (perforirani lim) safety screen of perforated plate

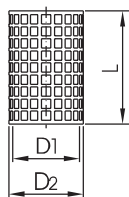

| DN | D1 | D2 | L | Tež.[kg] |
|-------------|-----|-----|-----|----------|
| 10 | 19 | 21 | 46 | 0,01 |
| 15 | 25 | 27 | 46 | 0,01 |
| 20 | 29 | 31 | 46 | 0,01 |
| 25 + 1" | 34 | 36 | 60 | 0,01 |
| 32 + 1 1/4" | 41 | 43 | 60 | 0,02 |
| 40 + 1 1/2" | 52 | 54 | 60 | 0,02 |
| 50 + 2" | 63 | 65 | 60 | 0,03 |
| 65 + 2 1/2" | 78 | 80 | 74 | 0,04 |
| 80 + 3" | 94 | 96 | 74 | 0,04 |
| 100 + 4" | 113 | 115 | 102 | 0,07 |
| 125 | 143 | 145 | 144 | 0,12 |
| 150 | 173 | 175 | 158 | 0,17 |

TEHNIČKE INFORMACIJE

Polikarbonat (cilindar za vidno staklo)

| | |
|-----------------------------------|--|
| Boja: | Providno (providnost > 86%) |
| Materijal: | Termoplastični polimer |
| Radna temperatura: | do 120°C, veoma kratko za vreme čišćenja |
| tip. primena: | <ul style="list-style-type: none"> - za zaštitni cilindar za vidno staklo. - elastičan i otporan na udarce. - proziran. - otporan na neorganske i većinu organskih kiselina, oksidaciju i redukujuće agense, neutralne i kisele rastvore soli, razne vrste masti, voskova i ulja. |
| Ograničenja: | <ul style="list-style-type: none"> - nije otporan na ogrebotine. - nije otporan na vodene i alkoholne alkalne rastvore, gas amonijaka i njegove rastvore i amine. - bubri u dodiru sa benzenom, hlor-benzenom, tetralinom, acetonom, etil-acetatom, acetonitrilom i ugljenik-tetrahloridom. - nije namenjen za delove koji dolaze u dodir sa proizvodom. |
| Preporučena sredstva za čišćenje: | <ul style="list-style-type: none"> - Fa. WIGOL: 30 20 04, 30 20 00, 1085, 60 80 25 - Fa. WEBCO: „alcip“ |